

## Single-phase Microinverter

# USER MANUAL

---

HMS-350-1T-NA  
HMS-400-1T-NA  
HMS-450-1T-NA  
HMS-500-1T-NA

## About Microinverter

This system is composed of a group of microinverters that convert direct current (DC) into alternating current (AC) and feed the power to the public grid. The system is designed for 1-in-1 microinverters, i.e., one microinverter is connected with one PV module.

Each microinverter works independently so as to guarantee the maximum power generation of each PV module. This setup is highly flexible and reliable as the system enables direct control of the production of each PV module.

## About the Manual

This manual contains important instructions for HMS-350-1T-NA/HMS-400-1T-NA/HMS-450-1T-NA/HMS-500-1T-NA microinverters and users shall read in its entirety before installing or commissioning the equipment. For safety reasons, only qualified technicians who have received training or demonstrate relevant skills can install and maintain this microinverter under the guidance of this document.

## Other Information

Product information is subject to change without notice. User manual will be updated regularly, so please refer to Hoymiles official website at [www.hoymiles.com](http://www.hoymiles.com) for the latest version.

# CONTENTS

<b>1. Important Notes</b>	<b>4</b>
1.1 Product Range	4
1.2 Target Group	4
1.3 Symbols Used	4
1.4 Radio Interference Statement	4
<b>2. About Safety</b>	<b>5</b>
2.1 Important Safety Instructions	5
2.2 Explanation of Symbols	6
<b>3. About Product</b>	<b>7</b>
3.1 About PV Microinverter System	7
3.2 About Microinverter	7
3.3 About 1-in-1 Unit	8
3.4 About Sub-1G Technology	8
3.5 Highlights	8
3.6 Terminals Introduction	9
3.7 Dimensions (mm)	9
<b>4. Installation Preparation</b>	<b>10</b>
4.1 Position and Space Required	10
4.2 Connecting Multiple PV Modules to Microinverter	10
4.3 Installation Tools	11
4.4 AC Branch Circuit Capacity	11
4.5 Precautions	12
<b>5. Microinverter Installation</b>	<b>13</b>
5.1 Accessories	13
5.2 Installation Steps	13
<b>6. Troubleshooting</b>	<b>17</b>
6.1 Troubleshooting List	17
6.2 LED Indicator Status	20
6.3 On-site Inspection (For qualified installer only)	21
6.4 Routine Maintenance	21
6.5 Microinverter Replacement	22
<b>7. Decommission</b>	<b>23</b>
7.1 Decommission	23
7.2 Storage and Transportation	23
7.3 Disposal	23
<b>8. Technical Data</b>	<b>24</b>
<b>9. Grid Support Details</b>	<b>25</b>
<b>10. Appendix 1:</b>	<b>28</b>
10.1 Installation Map	28
<b>11. Appendix 2:</b>	<b>29</b>
11.1 WIRING DIAGRAM –120VAC / 240VAC SPLIT PHASE:	29
11.2 WIRING DIAGRAM – 120VAC / 208VAC THREE PHASE:	30

# 1. Important Notes

## 1.1 Product Range

This manual describes the assembly, installation, commissioning, maintenance and troubleshooting of the following models of Hoymiles Microinverter:

- HMS-350-1T-NA
- HMS-400-1T-NA
- HMS-450-1T-NA
- HMS-500-1T-NA

\*Note: "350" means peak power 350 W, "400" means peak power 400 W, "450" means peak power 450 W, "500" means peak power 500 W. "NA" means this model is for North America.



\*Note: HMS-350/400/450/500-1T-NA is only compatible with Hoymiles gateway DTU-Pro-S and DTU-Lite-S.

## 1.2 Target Group

This manual is only for qualified technicians. For safety purposes, only those who have been trained or demonstrate relevant skills can install and maintain this microinverter under the guidance of this document.

## 1.3 Symbols Used

The safety symbols in this user manual are shown as below.

Symbol	Description
	This indicates a hazardous situation that can result in deadly electric shocks, other serious physical injuries, or fire incidents.
	This indicates that directions must be strictly followed to avoid safety hazards including equipment damage and personal injury.
	This indicates that the act is forbidden. You should stop, use caution and fully understand the operations explained before proceeding.

## 1.4 Radio Interference Statement

This microinverter has been tested and complies with the requirements of FCC, meaning that it will not be affected by electromagnetic interference. Please note that incorrect installation may cause electromagnetic disturbances.

You can turn the equipment off and on to see if radio or television reception is interfered by this equipment. If this equipment does cause harmful interference to radio or television, please try the following measures to fix the interference:

- 1) Relocate other apparatus' antenna.
- 2) Move the microinverter farther away from the antenna.
- 3) Separate the microinverter and the antenna with metal/concrete materials or roof.
- 4) Contact your dealer or an experienced radio/TV technician for help.







## 2. About Safety

### 2.1 Important Safety Instructions

The HMS-350-1T-NA/HMS-400-1T-NA/HMS-450-1T-NA/HMS-500-1T-NA microinverter is designed and tested according to international safety requirements. However, certain safety precautions must be taken when installing and operating this inverter. The installer must read and follow all instructions, cautions and warnings in this installation manual.

<ul style="list-style-type: none"> <li>All operations including transportation, installation, start-up and maintenance must be carried out by qualified, trained personnel.</li> </ul>
<ul style="list-style-type: none"> <li>Check the product before installation to make sure there is no damage caused during transportation because such damage can compromise the insulation integrity and safety clearances. Choose installation location carefully and adhere to specified cooling requirements. Unauthorized removal of necessary protections, improper use, incorrect installation and operation may cause damage to the equipment or incur serious safety and shock hazards.</li> </ul>
<ul style="list-style-type: none"> <li>You should get necessary approvals from local power operator before connecting the microinverter to the power grid. This connection must be made only by qualified technical personnel. It is the responsibility of the installer to provide external disconnect switches and Over Current Protection Devices (OCPD).</li> </ul>
<ul style="list-style-type: none"> <li>Each input of the inverter is connected to one PV module. Do not connect batteries or other sources of power supply. The inverter can be used only if all the technical parameters are observed and applied.</li> </ul>
<ul style="list-style-type: none"> <li>Do not install the equipment in flammable, explosive, corrosive, extremely hot/cold, and humid environment. Do not use the equipment when safety devices in these environments are not working.</li> </ul>
<ul style="list-style-type: none"> <li>Personal protective equipment such as gloves and goggles must be used during installation.</li> </ul>
<ul style="list-style-type: none"> <li>Inform the manufacturer about non-standard installation conditions.</li> </ul>
<ul style="list-style-type: none"> <li>Do not use the equipment if any operating anomalies are found.</li> </ul>
<ul style="list-style-type: none"> <li>All repairs must be done with qualified spare parts which must be installed in accordance with their intended use and by a licensed contractor or authorized Hoymiles service representative.</li> </ul>
<ul style="list-style-type: none"> <li>Liabilities arising from components that are not produced by Hoymiles are on the part of their respective manufacturers.</li> </ul>
<ul style="list-style-type: none"> <li>Whenever the inverter has been disconnected from the public grid, please be extremely careful as some components can retain charge sufficient to create a shock hazard. Before touching any part of the inverter, please ensure the surface and the whole equipment are within the limit of safe temperature and voltage potential.</li> </ul>
<ul style="list-style-type: none"> <li>Hoymiles is not liable for any damage caused by incorrect or improper operation.</li> </ul>
<ul style="list-style-type: none"> <li>Electrical installation and maintenance shall be conducted by licensed electrician and shall comply with local wiring rules.</li> </ul>

## 2.2 Explanation of Symbols

Symbol	Usage
	<p><b>Treatment</b></p> <p>To comply with European Directive 2002/96/EC on Waste Electrical and Electronic Equipment and its implementation as national law, electrical equipment that has reached the end of its life must be collected separately and returned to an approved recycling facility. Any device no longer needed must be returned to an authorized dealer or approved collection and recycling facility.</p>
	<p><b>Caution</b></p> <p>Do not come within 8 inches (20 cm) of the microinverter when it is in operation.</p>
	<p><b>Danger of high voltage</b></p> <p>High voltage in the microinverter can cause dangers to life.</p>
	<p><b>Beware of hot surface</b></p> <p>The inverter can become hot during operation. Avoid contact with metal surfaces during operation.</p>
	<p><b>CE mark</b></p> <p>The inverter complies with the Low Voltage Directive for the European Union.</p>
	<p><b>FCC mark</b></p> <p>The inverter complies with the FCC standards.</p>
	<p><b>Read manual first</b></p> <p>Please read the installation manual first before installation, operation and maintenance.</p>

### 3. About Product

#### 3.1 About PV Inverter System

A typical grid-tied PV inverter system includes PV modules, PV inverter, meter and power grid, as shown below. PV inverter converts the DC power generated by PV modules into AC power that meets the requirements of the power grid. The AC power is then fed into the grid via meter.

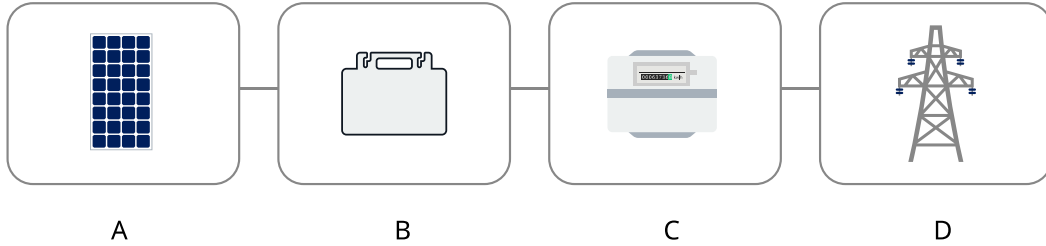

A	PV module
B	PV inverter
C	Grid-connected metering device
D	Power grid

#### 3.2 About Microinverter

PV Microinverter is a module-level solar inverter that tracks the maximum DC power point of each PV module, which is known as Maximum Power Point Tracking (MPPT).

This function of module-level MPPT means that when a PV module fails or is shaded, other modules will not be affected, boosting the overall power production of the system.

Microinverter can monitor the current, voltage and power of each module to realize module-level data monitoring.

Moreover, microinverter only carries a few dozen volts of DC voltage (less than 80 volts), which reduces safety hazards to the greatest extent.

Hoymiles microinverters feature module-level monitoring. Microinverter data are collected by DTU via wireless transmission and are sent to Hoymiles motoring platform S-Miles Cloud.

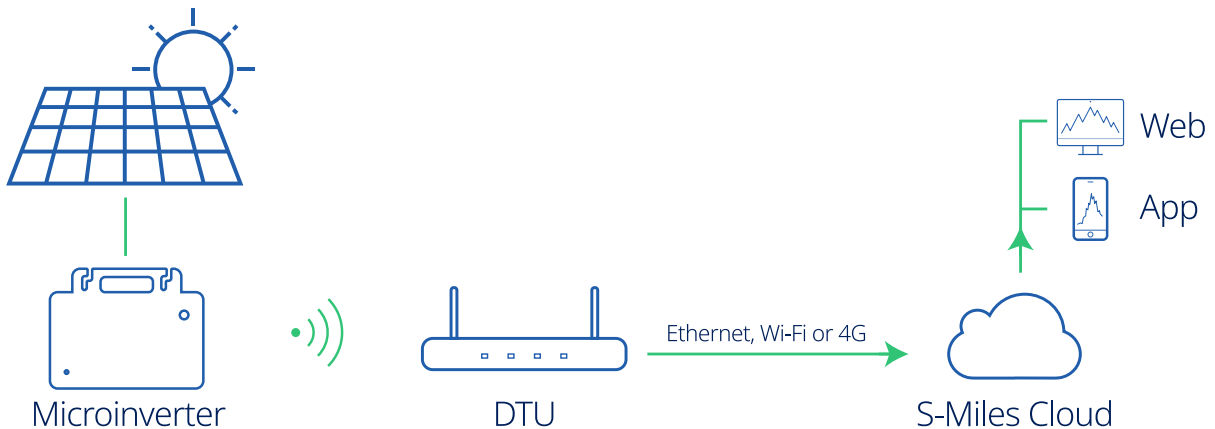

### 3.3 About 1-in-1 Unit

Microinverters can be divided into 1-in-1, 2-in-1, 4-in-1, etc., depending on how many PV modules are connected to them. This means that the microinverter can connect to one module, two modules and four modules respectively, as shown below.

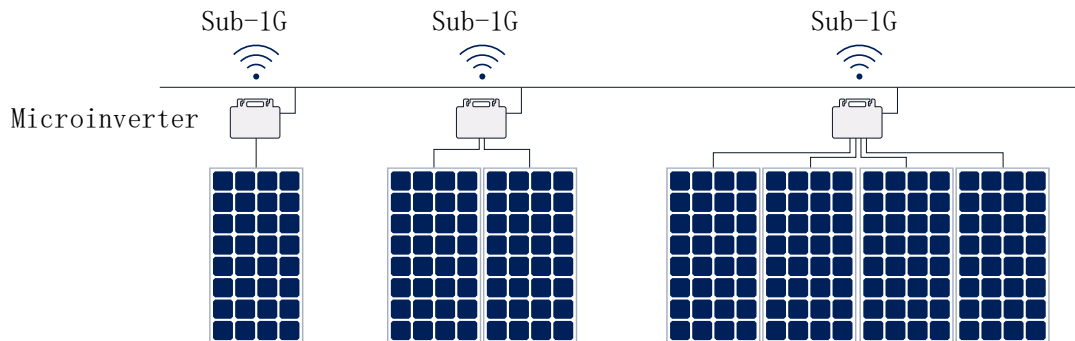

This manual is about Hoymiles 1-in-1 microinverter. With peak output power up to 500 VA, Hoymiles new HMS-500 series rank among the highest for 1-in-1 microinverters.

### 3.4 About Sub-1G Technology

HMS-500 series of microinverter adopts the new Sub-1G wireless solution which enables more stable communication with Hoymiles gateway DTU. Sub-1G technology is particularly useful for PV microinverters and is different from 2.4GHz in that it has substantially longer range and better interference suppression performance.

**Range of Sub-1GHz wireless:** Unlike Wi-Fi or Zigbee which both operate on the 2.4 GHz band, Sub-1GHz operates on the 868 MHz or the 915 MHz band. Generally speaking, Sub-1GHz wireless transmission covers 1.5 to 2 times longer distance than the 2.4GHz spectrum.

**Interference:** Sub-1GHz wireless networking can handle interference better. This is because it operates on a lower frequency, so the communication between the microinverter and the DTU is more stable. As a result, it is especially useful in industrial or commercial PV power plants.

**Lower Power Consumption:** Sub-1GHz wireless communication uses less power than Wi-Fi or Zigbee.

Because of the long range and better interference suppression performance, Sub-1GHz networking is particularly well-suited for rooftop PV power stations.

### 3.5 Highlights

- Peak output power up to 350/400/450/500 W
- Peak efficiency 96.50%
- Static MPPT efficiency 99.80%, Dynamic MPPT efficiency 99.76% in overcast weather
- Power factor (adjustable) 0.8 leading.....0.8 lagging
- Sub-1G for stronger communication with DTU
- High reliability: IP67 (NEMA 6) enclosure, 6000 V surge protection



**3.6 Terminals Introduction**

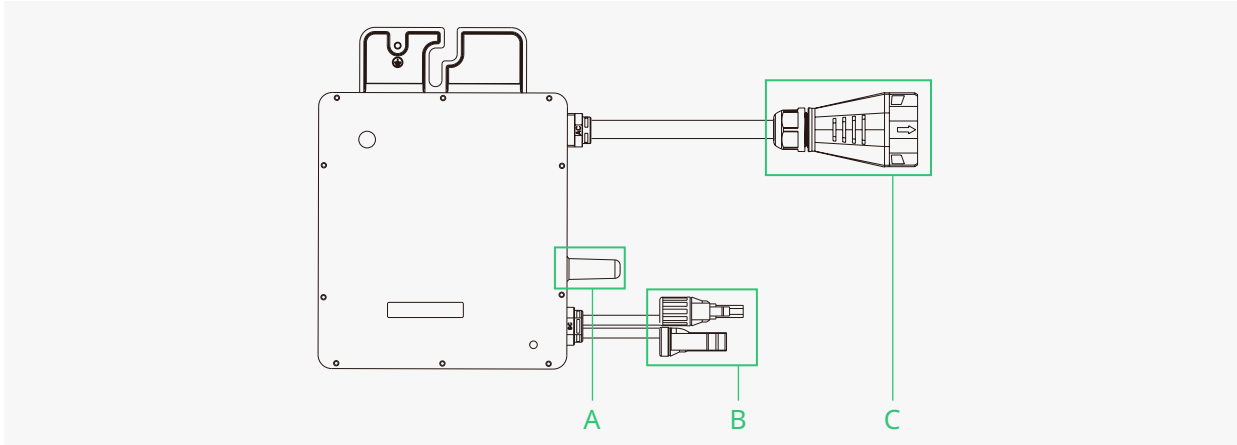

Object	Description
A	Sub-1G Wireless Terminal
B	DC Connectors
C	AC Sub Connector

**3.7 Dimensions (mm)**

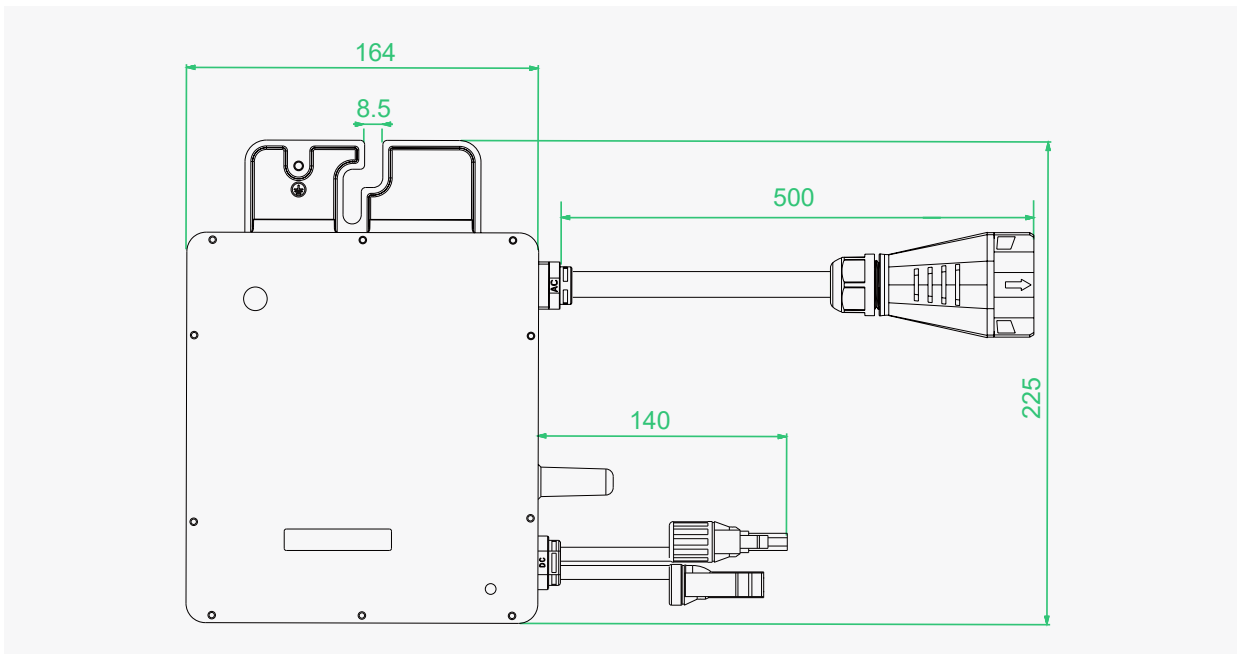

## 4. Installation Preparation

### 4.1 Position and Space Required

Please install the microinverter and all DC connections under the PV module to avoid direct sunlight, rain exposure, snow buildup, UV etc. The silver side of the microinverter should be up and facing the PV module.

Leave a minimum of 2 cm of space around the microinverter enclosure to ensure ventilation and heat dissipation.

### 4.2 Connecting PV Module to Microinverter

General Guidelines:

1. PV modules should be connected to DC input ports of a microinverter.
2. Use DC extension cable when the original cable is not long enough. Please consult the local power operator to make sure that the DC cable complies with local regulations.

The typical wiring method is shown below.

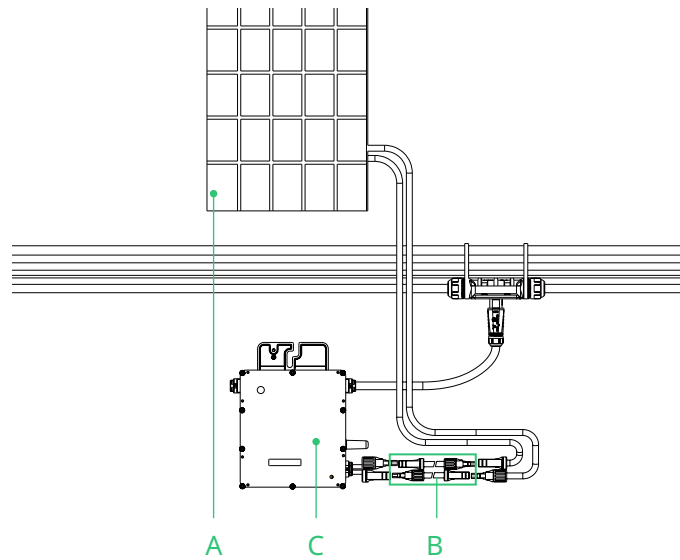

A	PV module
B	DC extension cable
C	Microinverter

Note: The voltage of modules (considering the effect of local temperature) must not exceed the maximum input voltage of the microinverter. Otherwise, the microinverter may be damaged (refer to the Technical Data section to determine the absolute maximum input voltage).

### 4.3 Installation Tools

Besides tools recommended below, other auxiliary tools can also be used on site.

Screwdriver	Multimeter
Socket Wrench or Allen wrench	Marker pen
Diagonal pliers	Steel tap
Wire cutters	Cable tie
Wire stripper	Torque and adjustable wrench
Utility knife	

Safety glove	Dust masks
Protective goggles	Safety shoes

### 4.4 AC Branch Circuit Capacity

Hoymiles HMS-350-1T-NA/HMS-400-1T-NA/HMS-450-1T-NA/HMS-500-1T-NA can be used with 12AWG or 10AWG AC Trunk Cable and the AC Trunk Connector which are provided by Hoymiles. The number of microinverters on each 12AWG or 10AWG AC branch shall not exceed the limit as shown below.

	HMS-350-1T-NA	HMS-400-1T-NA	HMS-450-1T-NA	HMS-500-1T-NA	Maximum over current protection device (OCPD)
Maximum number per 12AWG branch	10@208 V 12@240 V	9@208 V 10@240 V	8@208 V 9@240 V	7@208 V 8@240 V	20 A
Maximum number per 10AWG branch	15@208 V 18@240 V	13@208 V 16@240 V	12@208 V 14@240 V	10@208 V 12@240 V	30 A

Note:

1. The number of microinverters that can be connected to each AC branch is determined by the ampacity (also known as current-carrying capacity) of the cable.
2. 1-in-1, 2-in-1 and 4-in-1 microinverters can be connected to the same AC branch, as long as the total current does not exceed the ampacity specified in local regulations.

## 4.5 Precautions

The equipment is installed based on the system design and the location of installation.

<ul style="list-style-type: none"><li>• The installation must be done with the equipment disconnected from the grid (power disconnect switch open) and with the PV modules shaded or isolated.</li></ul>
<ul style="list-style-type: none"><li>• Make sure the environmental conditions fit the microinverter's requirement (degree of protection, temperature, humidity, altitude, etc.) as specified in the Technical Data section.</li></ul>
<ul style="list-style-type: none"><li>• Avoid direct sunlight to prevent power derating which can be caused by an increase in the internal temperature of the microinverter.</li></ul>
<ul style="list-style-type: none"><li>• Keep the inverter in well-ventilated place to avoid overheating.</li></ul>
<ul style="list-style-type: none"><li>• Keep the inverter away from gases or flammable substances.</li></ul>
<ul style="list-style-type: none"><li>• Avoid electromagnetic interference because it can compromise the normal operation of electronic equipment.</li></ul>

Installation location shall meet the following conditions:

<ul style="list-style-type: none"><li>• Install only on structures specifically designed for PV modules (supplied by installation technicians).</li></ul>
<ul style="list-style-type: none"><li>• Install microinverter underneath PV modules to make sure it works in the shadow. Nonobservance may cause the derating of inverter production.</li></ul>

## 5. Microinverter Installation

### 5.1 Accessories

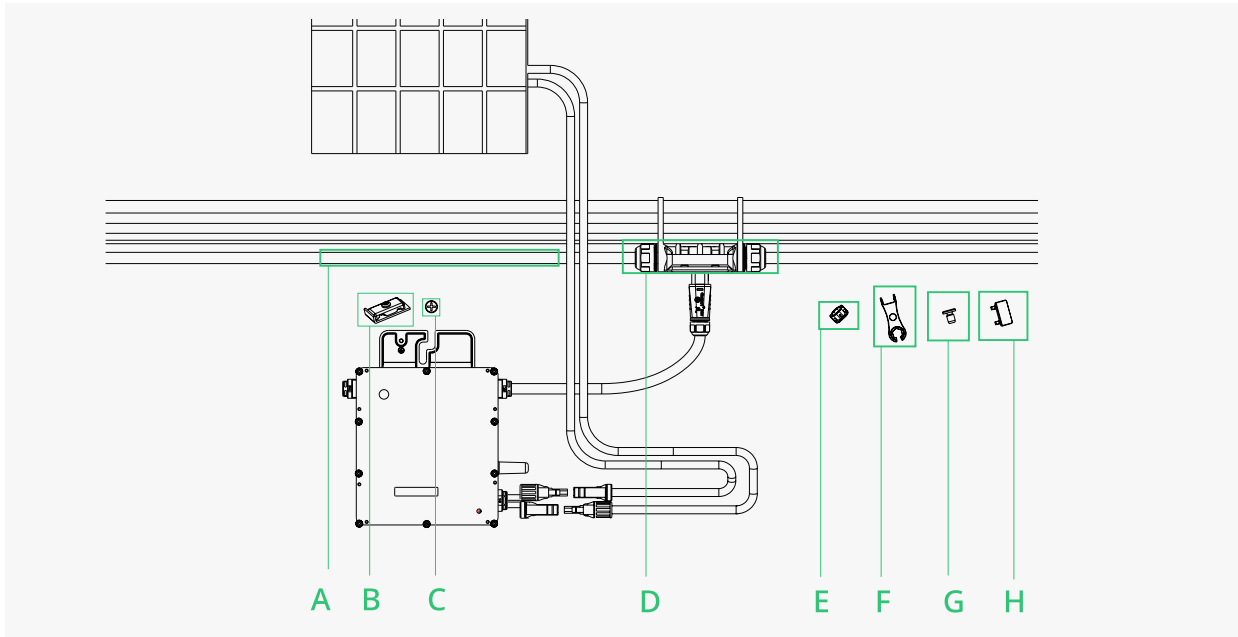

	Description
A	AC Trunk Cable, 12/10 AWG Cable
B	Grounding Electrode
C	M8 × 25 screws (Prepared by the installer)
D	AC Trunk Connector
E	AC Trunk End Cap
F	AC Trunk Port Disconnect Tool
G	AC Trunk Connector Unlock Tool
H	AC Trunk Port Cap

\*Note: All accessories above are not included in the package and should be purchased separately.

### 5.2 Installation Steps

The order of Step 1 and Step 2 can be reversed according to your planned needs.

#### Step 1. Plan and Install the Microinverter

A) Mark the position of each microinverter on the rail according to the PV module layout.

B) Fix the screws on the rail.

C) Hang the microinverter on the screws, and tighten the screws. The silver cover side of the microinverter should be facing the panel.

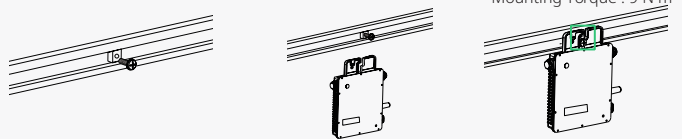

The AC cable contains earth wire, so grounding can be done directly with it. For regions that have special requirements, we offer optional grounding brackets that can be used to complete the external grounding.

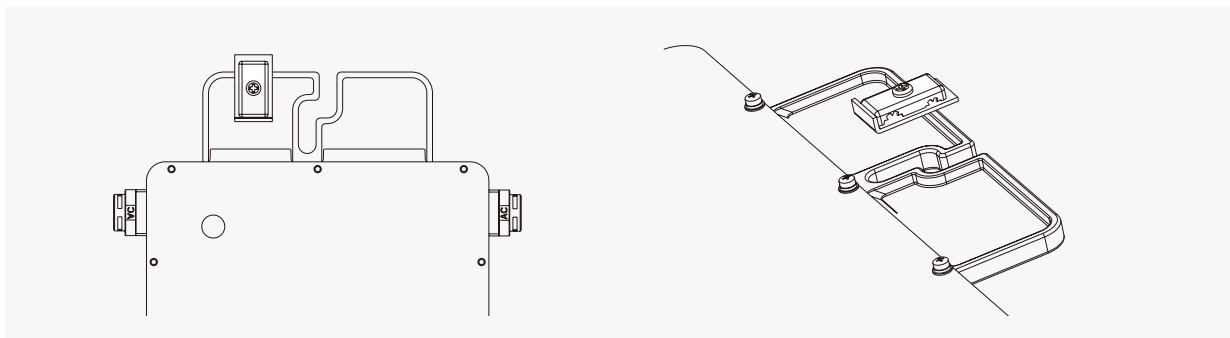

Route a continuous grounding cable through grounding brackets for each microinverter to the AC grounding electrode that conforms with local regulations.

Torque each grounding cleat screw to 2 N·m.

Note:

1. Microinverter installation and DC connections must be done under the PV module to avoid direct sunlight, rain exposure, snow buildup, UV etc.
2. Leave a minimum of 2 cm of space around the microinverter enclosure to ensure ventilation and heat dissipation.
3. Mounting torque of the 8 mm screw is 9 N·m. Do not over torque.
4. Do not pull or hold the AC cable with your hand. Hold the handle instead.

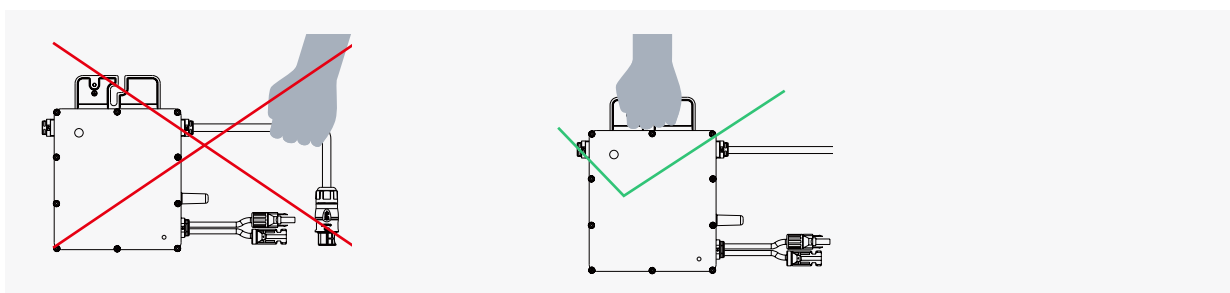

## Step 2. Plan and Build the AC Trunk Cable

AC Trunk Cable is used to connect the microinverter to the power distribution box.

- A) Select the appropriate AC Trunk Cable according to the spacing between microinverters. The connectors of the AC Trunk Cable should be spaced based on the spacing between microinverters to ensure that they can properly match. (Hoymiles provides AC Trunk Cable with different AC Trunk Connector spacing.)
- B) Determine how many microinverters you plan to install on each AC branch and prepare AC Trunk Connectors accordingly.
- C) Take out segments of AC Trunk Cable as you need to make AC branch.
  - 1) Disassemble the AC Trunk Connector and remove the cable.

- Unlock the connector's upper cover with AC Trunk Connector Unlock Tool.

- Loosen the three screws with the screwdriver. Untighten the cap and remove the cable.

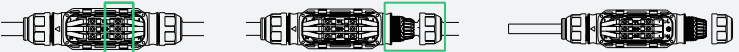

2) Install the AC Trunk End Cap at one side of AC Trunk Cable (the end of AC Trunk Cable).

- Insert the AC Trunk End cap and screw the cap back to port, then tighten the cap.

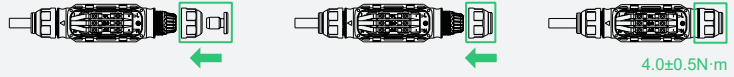

- Plug the upper cover back to the Trunk connector.

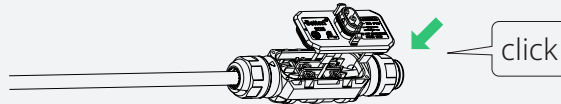

3) Install AC end cable on the other side of AC Trunk Cable (connected to the distribution box).

- Unlock the port upper cover, loosen the screws with the screwdriver and remove the extra cable. (Skip this step if there is no cable at this side.)

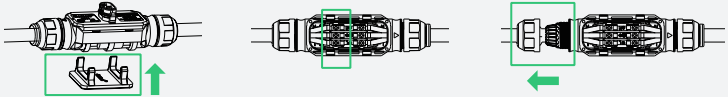

- Prepare a segment of AC cable of suitable length to connect to the distribution box, with stripping requirements fulfilled.

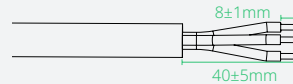

- Insert the cable into the cap in a way that the L, N and PE are in corresponding slots.

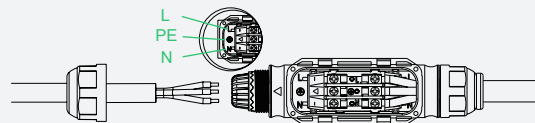

- Tighten the screws, and then tighten the cap back to the port.

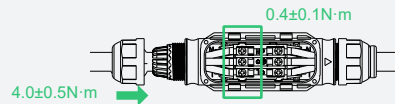

- Plug the upper cover back to the Trunk connector.

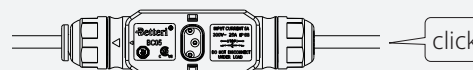

Note:

1. Tightening torque of the cap:  $4.0 \pm 0.5$  N·m. Please do not over torque.
2. Torque of locking screw:  $0.4 \pm 0.1$  N·m.
3. Do not damage the sealing ring in the AC Trunk Connector during disassembly and assembly.
4. Wires used in Hoymiles Microinverter:

PE (Green-yellow)



N (Black)



L1 (Red)



D) Repeat the above steps to make all the AC Trunk Cables you need. Then lay out the cable on the rail as appropriate so that the microinverters can be connected to the Trunk connectors.

E) Attach the AC Trunk Cable to the mounting rail and fix the cable with tie wraps.

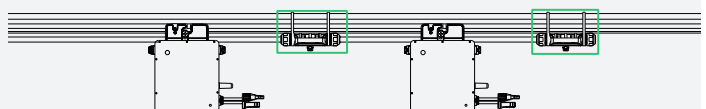

### Step 3. Complete the AC Connection

A) Plug the AC Sub Connector of the microinverter into the AC Trunk Connector until you hear the click.

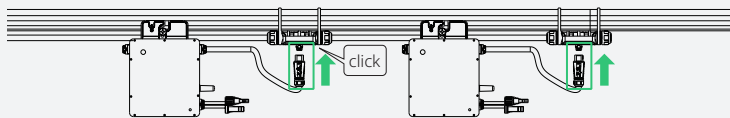

B) Connect the AC end cable to the distribution box, and wire it to the local grid network.

C) Please plug the AC Trunk Port Cap in any vacant AC Trunk Port to make it water- and dust-proof.

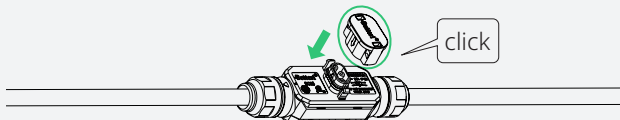

Note:

1. Make sure that the AC Trunk Connectors are kept away from any drainage channels.
2. In case you need to remove the microinverter AC cable from AC Trunk Connector, insert the AC Trunk Port Disconnect Tool into the side of AC Sub Connector to complete the removal.

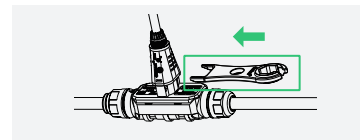

### Step 4. Create an Installation Map

- A) Peel the removable serial number label from each microinverter.
- B) Affix the serial number label to the respective location on the installation map (please refer to the appendix).

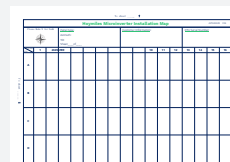
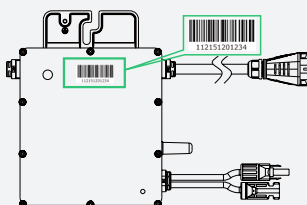

### Step 5. Connect PV Modules

- A) Mount the PV modules above the microinverter.
- B) Connect the PV modules' DC cables to the DC input side of the microinverter.

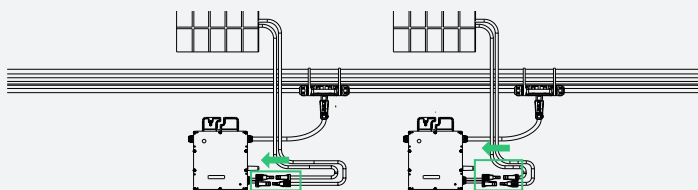

Note:

1. Make sure that the AC Trunk Connectors are kept away from any drainage channels.
2. In case you need to remove the microinverter AC cable from AC Trunk Connector, insert the AC Trunk Port Disconnect Tool into the side of AC Sub Connector to complete the removal.

### Step 6. Energize the System

- A) Turn on the AC breaker of the branch circuit.
- B) Turn on the main AC breaker of the house. Your system will start to generate power in about two minutes.

### Step 7. Set Up Monitoring System

Refer to the "DTU User Manual", "DTU Quick Installation Guide", and "Quick Installation Guide for S-Miles Cloud" to install the DTU and set up the monitoring system.

Product information is subject to change without notice. (Please download reference manuals at [www.hoymiles.com](http://www.hoymiles.com))



## 6. Troubleshooting

### 6.1 Troubleshooting List

Code	Alarm range	Alarm status	Handling suggestions
121		Over temperature protection	<ol style="list-style-type: none"> <li>1. Check the ventilation and ambient temperature at the microinverter installation location.</li> <li>2. If the ventilation is poor or the ambient temperature exceeds the limit, please improve the ventilation and heat dissipation.</li> <li>3. If the problem persists when ventilation and ambient temperature are appropriate, contact your dealer or Hoymiles technical support team.</li> </ol>
124		Shut down by remote control	<ol style="list-style-type: none"> <li>1. Check the status of zero export management and whether the microinverters were manually shut down.</li> <li>2. If the alarm still persists, please contact your dealer or Hoymiles technical support team.</li> </ol>
125		Grid configuration parameter error	<ol style="list-style-type: none"> <li>1. Check if the grid configuration parameter is correct and upgrade.</li> <li>2. If the fault still exists, contact your dealer or Hoymiles technical support team.</li> </ol>
127		Firmware error	<ol style="list-style-type: none"> <li>1. Check if the firmware is correct and has been upgraded.</li> <li>2. Check the communication between DTU and Hoymiles monitoring system, and between DTU and microinverter. Then try again.</li> <li>3. If the fault still exists, contact your dealer or Hoymiles technical support team.</li> </ol>
129		Abnormal bias	<ol style="list-style-type: none"> <li>1. If the alarm occurs occasionally and the microinverter can still work normally, no special treatment is required.</li> <li>2. If the alarm occurs frequently and cannot be recovered, contact your dealer or Hoymiles technical support team.</li> </ol>
130		Offline	<ol style="list-style-type: none"> <li>1. Please make sure that the microinverter works normally (check if the DC voltage is within normal range and confirm the status of the LED indicator).</li> <li>2. Check if the SN on microinverter label is the same as on the monitoring platform.</li> <li>3. Check the communication status between the DTU and Hoymiles monitoring system, and between the DTU and the microinverter. If the communication is poor, try to make some improvements.</li> <li>4. If the alarm occurs frequently and cannot be recovered, contact your dealer or Hoymiles technical support team.</li> </ol>
141	Grid	Grid overvoltage	<ol style="list-style-type: none"> <li>1. If the alarm occurs occasionally, the grid voltage may be just abnormal temporarily. The microinverter can automatically recover after grid voltage becomes normal.</li> <li>2. If the alarm occurs frequently, check whether the grid voltage is within the acceptable range. If not, contact the local power operator or change the grid overvoltage protection limit in the grid profile via Hoymiles monitoring system with the consent of the local power operator.</li> </ol>
142	Grid	10 min value grid overvoltage	<ol style="list-style-type: none"> <li>1. If the alarm occurs occasionally, the grid voltage may be just abnormal temporarily. The microinverter can automatically recover after grid voltage becomes normal.</li> <li>2. If the alarm occurs frequently, check whether the grid voltage is within the acceptable range. If not, contact the local power operator or change the grid overvoltage protection limit via Hoymiles monitoring system with the consent of the local power operator.</li> </ol>

143	Grid	Grid undervoltage	<ol style="list-style-type: none"> <li>1. If the alarm occurs occasionally, the grid voltage may be just abnormal temporarily. The microinverter can automatically recover after grid voltage becomes normal.</li> <li>2. If the alarm occurs frequently, check whether the grid voltage is within the acceptable range. If not, contact the local power operator or change the grid undervoltage protection limit in the grid profile via Hoymiles monitoring system with the consent of the local power operator.</li> <li>3. If the fault still exists, check the AC switch or AC wiring.</li> </ol>
144	Grid	Grid overfrequency	<ol style="list-style-type: none"> <li>1. If the alarm occurs occasionally, the grid frequency may be just abnormal temporarily. The microinverter can automatically recover after grid frequency becomes normal.</li> <li>2. If the alarm occurs frequently, check whether the grid frequency is within the acceptable range. If not, contact the local power operator or change the grid overfrequency protection limit via Hoymiles monitoring system with the consent of the local power operator.</li> </ol>
145	Grid	Grid underfrequency	<ol style="list-style-type: none"> <li>1. If the alarm occurs occasionally, the grid frequency may be just abnormal temporarily. The microinverter can automatically recover after grid frequency becomes normal.</li> <li>2. If the alarm occurs frequently, check whether the grid frequency is within the acceptable range. If not, contact the local power operator or change the grid underfrequency protection limit via Hoymiles monitoring system with the consent of the local power operator.</li> </ol>
146	Grid	Rapid grid frequency change rate	<ol style="list-style-type: none"> <li>1. If the alarm occurs occasionally, the grid frequency may be just abnormal temporarily. The microinverter can automatically recover after grid frequency becomes normal.</li> <li>2. If the alarm occurs frequently, check whether the grid frequency change rate is within the acceptable range. If not, contact the local power operator or change the grid frequency change rate limit in the grid profile in the grid profile via Hoymiles monitoring system with the consent of the local power operator.</li> </ol>
147	Grid	Power grid outage	Please check whether the AC switch, branch breaker and AC wiring is normal.
148	Grid	Grid disconnection	Please check whether the AC switch, branch breaker and AC wiring is normal.
149	Grid	Island detected	<ol style="list-style-type: none"> <li>1. If the alarm occurs occasionally, the grid frequency may be just abnormal temporarily. The microinverter can automatically recover after grid voltage becomes normal.</li> <li>2. If the alarms occur frequently on all the microinverters in your station, contact the local power operator to check whether there is a grid island.</li> <li>3. If the alarm still exists or happens on only several microinverters, please contact your dealer or Hoymiles technical support.</li> </ol>
205	MPPT-A	Input overvoltage	<ol style="list-style-type: none"> <li>1. Please make sure that the PV module open-circuit voltage is less than or equal to the maximum input voltage.</li> <li>2. If the PV module open-circuit voltage is within the normal range, contact your dealer or Hoymiles technical support team.</li> </ol>
207	MPPT-A	Input undervoltage	<ol style="list-style-type: none"> <li>1. Please make sure that the PV module open-circuit voltage is not lower than minimum input voltage.</li> <li>2. If the PV module open-circuit voltage is within the normal range, contact your dealer or Hoymiles technical support team.</li> </ol>
209	PV-1	No input	<ol style="list-style-type: none"> <li>1. Please confirm whether this port is connected to the PV module.</li> <li>2. If the PV module is connected, please check the DC cable connection between this port and the PV module.</li> </ol>

213	MPPT-A	Abnormal wiring	1.Please check whether the DC connections on port 1 and 2 are correct. 2.Check if the DC extension cable is made correctly.
215	PV-1	Input overvoltage	Check the input voltage of PV-1 port.
216	PV-1	Input undervoltage	Check the input voltage of PV-1 port.
301-314		Device failure	1. If the alarm occurs occasionally and the microinverter can still work normally, no special treatment is required. 2. If the alarm occurs frequently and cannot be recovered, contact your dealer or Hoymiles technical support team.

## 6.2 LED Indicator Status

The LED flashes five times at start-up. All green flashes (1s gap) indicate normal start-up.

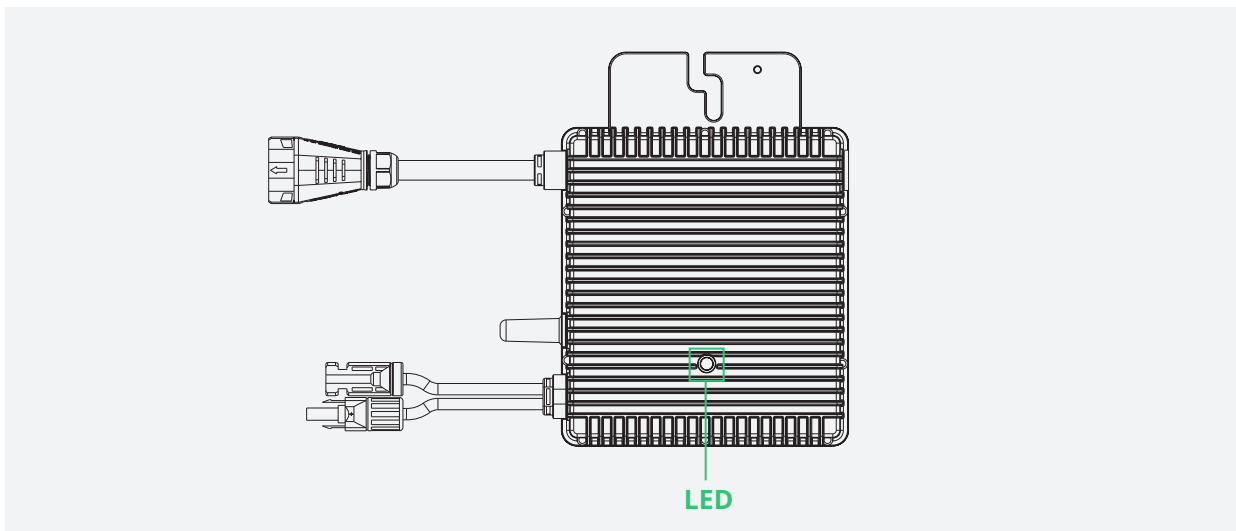

<b>(1) During Start-up</b>
<ul style="list-style-type: none"> <li>Flashing green five times (0.3s gap): Start-up success</li> <li>Flashing Red five times (0.3s gap): Start-up failure</li> </ul>
<b>(2) During Operation</b>
<ul style="list-style-type: none"> <li>Fast green flashes (1s gap): Producing power</li> <li>Slow green flashes (2s gap): Producing power but one input is abnormal</li> <li>Red flashes (0.5s gap): Invalid AC grid or hardware failure. Refer to Hoymiles Monitoring Platform for more details</li> <li>Red flashes (1s gap): Not producing power due to invalid AC grid</li> <li>Solid red: Hardware failure. Please refer to Hoymiles Monitoring Platform for more details</li> </ul>
<b>(3) Other Status</b>
<ul style="list-style-type: none"> <li>Red and Green flashes alternately: Firmware is broken</li> </ul>

\*Note:

- The microinverter is powered by DC side. If the LED light is not on, please check the DC side connection. If the connection and input voltage are normal, contact your dealer or hoymiles technical support team.
- All the faults are reported to the DTU. Refer to the local DTU app or Hoymiles Monitoring Platform for more information.







### 6.3 On-site Inspection (For qualified installer only)

Troubleshoot a malfunctioning microinverter according to the following steps.

1	Check if the utility voltage and frequency are within the respective range shown in Technical Data section of this manual.
2	Check the connection to the utility grid. Disconnect the AC and the DC power. Please note that when the inverter is in operation, disconnect the AC power first to de-energize the inverter, and then disconnect the DC power. Re-connect the PV modules to the microinverter. LED will flash red to indicate normal DC connection. Re-connect the AC power. LED will flash green for five times to indicate normal DC and AC connection. Never disconnect the DC wires while the microinverter is producing power. Re-connect the DC module connectors and wait for five short LED flashes.
3	Check the interconnection between all the microinverters on the AC branch circuit. Confirm that each inverter is energized by the utility grid as described in the previous step.
4	Make sure that every AC breaker is functioning properly and is closed.
5	Check the DC connection between the microinverter and the PV module.
6	Make sure that PV modules' DC voltage is within the allowable range shown in the Technical Data section of this manual.
7	If the problem persists, please call Hoymiles customer support.
	<u>Do not try to repair the microinverter by yourself. If the troubleshooting fails, please return it to the factory for replacement.</u>

### 6.4 Routine Maintenance

1. Only authorized personnel are allowed to carry out the maintenance operations and are responsible for reporting any anomalies.
2. Always use personal protective equipment provided by the employer during maintenance operation.
3. During normal operation, check the environmental conditions regularly to make sure that the conditions have not changed over time and that the equipment is not exposed to adverse weather conditions and has not been obstructed.
4. DO NOT use the equipment if any problems are detected. Restore its working conditions after the fault is fixed.
5. Conduct annual inspections on various components, and clean the equipment with a vacuum cleaner or special brushes.

	Do not attempt to dismantle or repair the microinverter! No user-serviceable parts inside for the safety and insulation reasons!
	The AC output wiring harness (AC drop cable on the microinverter) cannot be replaced. The equipment should be scrapped if the cord is damaged.
	Maintenance operations must be carried out with the equipment disconnected from the grid (power switch open) and the PV modules shaded or isolated, unless otherwise indicated.
	Never clean the equipment with rags made of filamentary or corrosive materials to avoid corrosion and electrostatic charges.
	Do not attempt to repair the product. All repairs should be done using only eligible spare parts.
	If all the microinverters are connected to the DTU-Pro-S, the DTU can limit the output power imbalance of all the microinverters between phases to below 3.68 kW if required. Please refer to "Hoymiles Technical Note Limit Phase Balance" for more details.



CAUTION

Each branch should have a circuit breaker. Central protection unit is unnecessary.

## 6.5 Microinverter Replacement

### a. How to remove the microinverter

- De-energize the AC branch circuit breaker.
- Remove the PV module from the rack, and cover the module.
- Check the equipment with an electric meter and make sure there is no current flowing in the DC wires between module and microinverter.
- Remove the DC connectors with DC disconnect tool.
- Remove the AC Sub Connector with AC disconnect tool.
- Loosen the fixing screws on the top of the microinverter and remove the microinverter from the PV racking.

### b. How to replace the microinverter in monitoring platform

- Please note down the new microinverter’s SN.
- Please make sure the AC branch circuit breaker is off, and install the replacement unit according to the microinverter installation steps.
- Go to the monitoring platform (if customer has already registered this station online), please access the “Device List” page and find the device that you just replaced. Please click “Device Maintenance” on the right side of the page, and select “Replace Device”. Input the new microinverter’s SN and click “OK” to complete the station change.

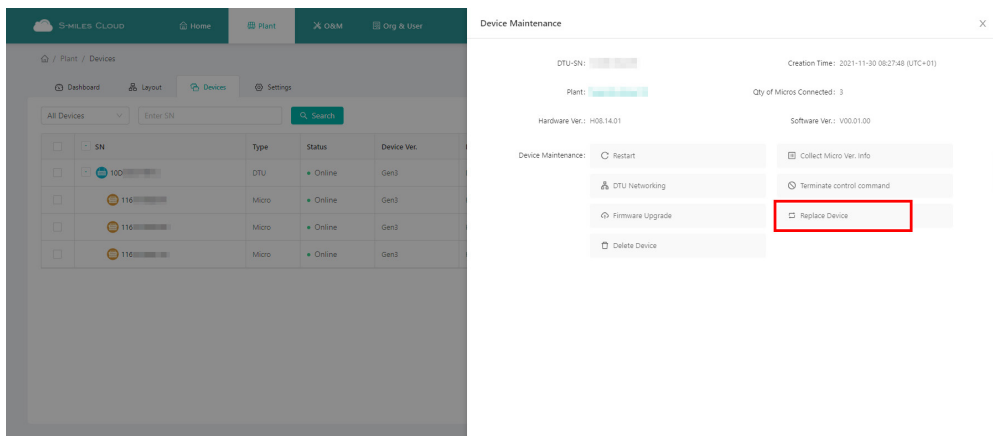
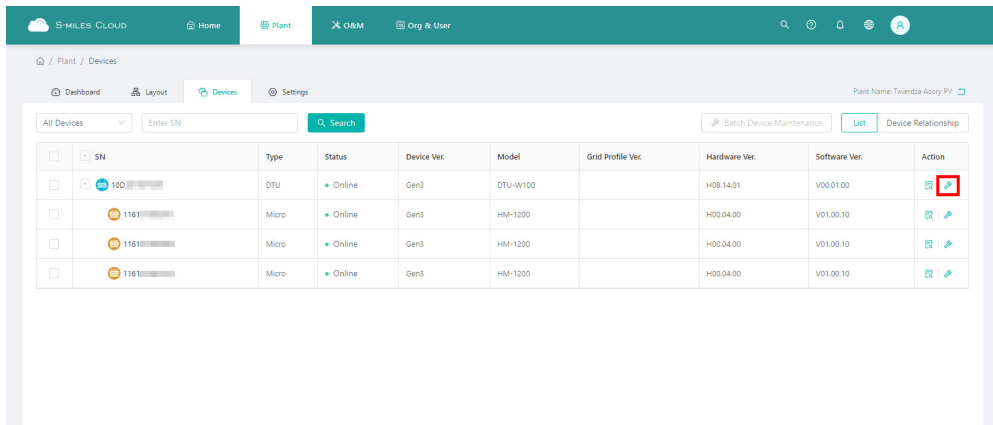

## 7. Decommission

### 7.1 Decommission

Disconnect the inverter from DC input and AC output, remove all connection cable from the microinverter, and remove the microinverter from the frame.

Please pack the microinverter in the original packaging. If the original packaging is no longer available, you can use a carton box that can hold 5 kg and can be fully closed.

### 7.2 Storage and Transportation

Hoymiles packages are specially designed to protect components so as to facilitate transportation and subsequent handling. Transportation of the equipment, especially by road, must be done in a way that can protect the components (particularly the electronic components) from violent shocks, humidity, vibration, etc. Please dispose of the packaging elements in appropriate ways to avoid unforeseen injury.

Please examine the conditions of the components to be transported. Upon receiving the microinverter, you should check the container for any external damage and verify the receipt of all items. Please call the carrier immediately if there is any damage or if any parts are missing. In case of any damage caused to the inverter, contact the supplier or authorized distributor to request a repair/return and ask for instructions regarding the process.

The storage temperature range of microinverter is -40 to 85°C.

### 7.3 Disposal

- If the equipment is not used immediately or is stored for a long period of time, make sure that it is properly packed. The equipment must be stored indoors with good ventilation and without any potential damage to the components of the equipment.
- Take a complete inspection when restarting the equipment after it has stopped operation for a long time.
- Please dispose of the microinverters properly in accordance with local regulations after they are scrapped because of potential harms to the environment.

## 8. Technical Data

	Be sure to verify the following before installing Hoymiles Microinverter System.
---	--

- Verify that the voltage and current specifications of the PV module match those of the microinverter.
  - The maximum open circuit voltage rating of the PV module must be within the operating voltage range of the microinverter.
  - We recommend that the maximum current rating at MPP should be equal to or less than the maximum input DC current.
- The output DC power of PV module shall not exceed 1.35 times of the output AC power of the microinverter. Refer to “Hoymiles Warranty Terms & Conditions” for more information.

Model	HMS-350-1T-NA		HMS-400-1T-NA		HMS-450-1T-NA		HMS-500-1T-NA	
<b>Input Data(DC)</b>								
Commonly used module power (W)	280 to 470+		320 to 540+		360 to 600+		400 to 670+	
Maximum input voltage (V)	60				65			
MPPT voltage range (V)	16-60							
Start-up voltage (V)	22							
Maximum input current (A)	13		14		15		16	
Maximum input short circuit current (A)	20		25		25		25	
<b>Output Data(AC)</b>								
Peak output power (VA)	350		400		450		500	
Maximum continuous output power (VA)	319		360		410		475	
Maximum continuous output current (A)	1.33	1.53	1.5	1.73	1.71	1.98	1.98	2.28
Nominal output voltage/range (V) <sup>1</sup>	240/211-264	208/183-228	240/211-264	208/183-228	240/211-264	208/183-228	240/211-264	208/183-228
Nominal frequency/range (Hz) <sup>1</sup>	60/55-65							
Power factor (adjustable)	> 0.99 default 0.8 leading ... 0.8 lagging							
Total harmonic distortion	< 3%							
Maximum units per 10AWG branch <sup>2</sup>	18	15	16	13	14	12	12	10
Maximum units per 12AWG branch <sup>2</sup>	12	10	10	9	9	8	8	7
<b>Efficiency</b>								
CEC peak efficiency	96.7%				96.5%			
Nominal MPPT efficiency	99.8%							
Night power consumption (mW)	< 50							
<b>Mechanical Data</b>								
Ambient temperature range (°C)	-40 to +65							
Dimensions (W × H × D mm)	182 × 164 × 30							
Weight (kg)	1.75							
Enclosure rating	Outdoor-NEMA6							
Cooling	Natural convection (no fans)							
<b>Features</b>								
Communication	Sub-1G							
Type of isolation	Galvanically Isolated HF Transformer							
Monitoring	S-Miles Cloud <sup>3</sup>							
Compliance	UL 1741, IEEE 1547, UL 1741 SA, CA Rule21, CSA C22.2 No. 107.1-16 FCC 15B, FCC 15C							
PV Rapid Shutdown	Conforms with NEC-2017 and NEC-2020 Article 690.12 and CEC-2021 Sec 64-218 Rapid Shutdown of PV Systems.							

\*1 Nominal voltage/frequency range can vary depending on local requirements.



\*2 Refer to local requirements for exact number of microinverters per branch.

\*3 Hoymiles Monitoring System



## 9. Grid Support Details

The HMS-350-1T-NA/HMS-400-1T-NA/HMS-450-1T-NA/HMS-500-1T-NA Microinverter is a grid support interactive inverter, which is also known as a Grid Support Utility Interactive Inverter. And these microinverters also comply with California Rule 21. The Grid Support functions are controlled on Hoymiles Monitoring Platform and the DTU is re- quired in this PV system.

 CAUTION	Only an authorized installer is allowed to make Grid profile adjustments by following the requirements of local electrical utility.
 CAUTION	Simultaneous use of Fixed Power Factor and Volt/Var is not supported.

### Manufacturer’s Stated Accuracy

Measurement	Default Tolerance of Measurement
Volts	+/- 1%
Watts	+/- 5%
VA <sub>r</sub>	+/- 6%
Power factor	+/- 0.05
Hz	+/- 0.1 Hz

### SA9: Low/High Voltage Ride Through (L/H VRT) and Must Trip Settings

Region	Voltage at PCC (% Nominal Voltage)	Ride-Through Until	Operating Mode	Maximum Trip Time (s)	Range of Adjustable Maximum Trip Time (s)
High Voltage 2 (HV2)	$V \geq 120$	N/A	N/A	0.16 sec.	0.16 sec.
High Voltage 1 (HV1)	$110 < V < 120$	12 sec.	Momentary Cessation	13 sec.	1-13 sec.
Near Nominal (NN)	$88 \leq V \leq 110$	Indefinite	Continuous Operation	N/A	N/A
Low Voltage 1 (LV1)	$70 \leq V < 88$	20 sec.	Mandatory Operation	21 sec.	21 sec.
Low Voltage 2 (LV2)	$50 \leq V < 70$	10 sec.	Mandatory Operation	11 sec.	11-21 sec.
Low Voltage 3 (LV3)	$V < 50$	1 sec.	Momentary Cessation	1.5 sec.	1.5-2 sec.

**SA10: Low/High Frequency Ride Through (L/H FRT) and Must Trip Settings**

Region	System Frequency Default Settings	Ride-Through Until (s)	Ride-Through Operational Mode	Trip Time Default (s)	Range of Adjustable Trip Time Default (s)
High Frequency 2 (HF2)	$f > 62$	No Ride-Through	N/A	0.16 sec.	0.16 sec.
High Frequency 1 (HF1)	$60.5 < f < 62$	299 sec.	Mandatory Operation	300 sec.	0.1-300 sec.
Near Nominal (NN)	$58.5 < f < 60.5$	Indefinite	Continuous Operation	N/A	N/A
Low Frequency 1 (LF1)	$57.0 < f < 58.5$	299 sec.	Mandatory Operation	300 sec.	0.1-300 sec.
Low Frequency 2 (LF2)	$f < 57.0$	No Ride-Through	Not Applicable	0.16 sec.	0.16 sec.
Low Voltage 3 (LV3)	$V < 50$	1 sec.	Momentary Cessation	1.5 sec.	1.5-2 sec.

**SA10: Low/High Frequency Ride Through (L/H FRT) and Must Trip Settings**

	Units	Adjustment Range		Tolerance
		Max	Min	
Ramp up rate	%I <sub>rated</sub> /s	100	1	+/- 4%
Soft ramp up rate	%I <sub>rated</sub> /s	100	0.1	+/- 4%

**SA10: Low/High Frequency Ride Through (L/H FRT) and Must Trip Settings**

	Adjustment Range	
	Max	Min
Inductive, under excited, power factor	-0.8	-1.0
Capacitive, overexcited, power factor	1.0	0.8

**Manufacturer’s Stated Accuracy**

	Units	HMS-350-1T-NA	HMS-400-1T-NA	HMS-450-1T-NA	HMS-500-1T-NA
Output power rating	W	319	360	410	475
Reactive power absorption (inductive, under excited)	VAr	102	115	131	152
Reactive power production (capacitive, overexcited)	VAr	102	115	131	152

**Manufacturer’s Stated Accuracy**

	Units	HMS-350-1T-NA	HMS-400-1T-NA	HMS-450-1T-NA	HMS-500-1T-NA
Output power rating	W	319	360	410	475
Manufacturer's stated P(f) accuracy	%Prated	5%	5%	5%	5%
Maximum slope of frequency droop	%Prated/Hz	100	100	100	100
Minimum slope of frequency droop	%Prated/Hz	20	20	20	20



**Manufacturer’s Stated Accuracy**

	Units	HMS-350-1T-NA	HMS-400-1T-NA	HMS-450-1T-NA	HMS-500-1T-NA
Output power rating	W	319	360	410	475
Output Power accuracy	%Prated	5%	5%	5%	5%
Maximum Slope of active power reduction	%Prated/Hz	50	50	50	50
Minimum Slope of active power reduction	%Prated/Hz	20	20	20	20

# 10. Appendix 1:

## 10.1 Installation Map

↑ To sheet \_\_\_\_\_

 Please Make N for North 		<b style="color: green;">Hoymiles Microinverter Installation Map</b>										DTU Serial Number AP040228 V1.4															
Panel type: Azimuth: Tilt: Sheet _____ of _____		Customer Information:								1	2	3	4	5	6	7	8	9	10	11	12	13	14	15	16		
COLUMN	ROW	1	2	3	4	5	6	7	8	9	10	11	12	13	14	15	16										
<b>A</b>																											
<b>B</b>																											
<b>C</b>																											
<b>D</b>																											

↓ To sheet \_\_\_\_\_

## 11. Appendix 2:

### 11.1 WIRING DIAGRAM -120VAC / 240VAC SPLIT PHASE:

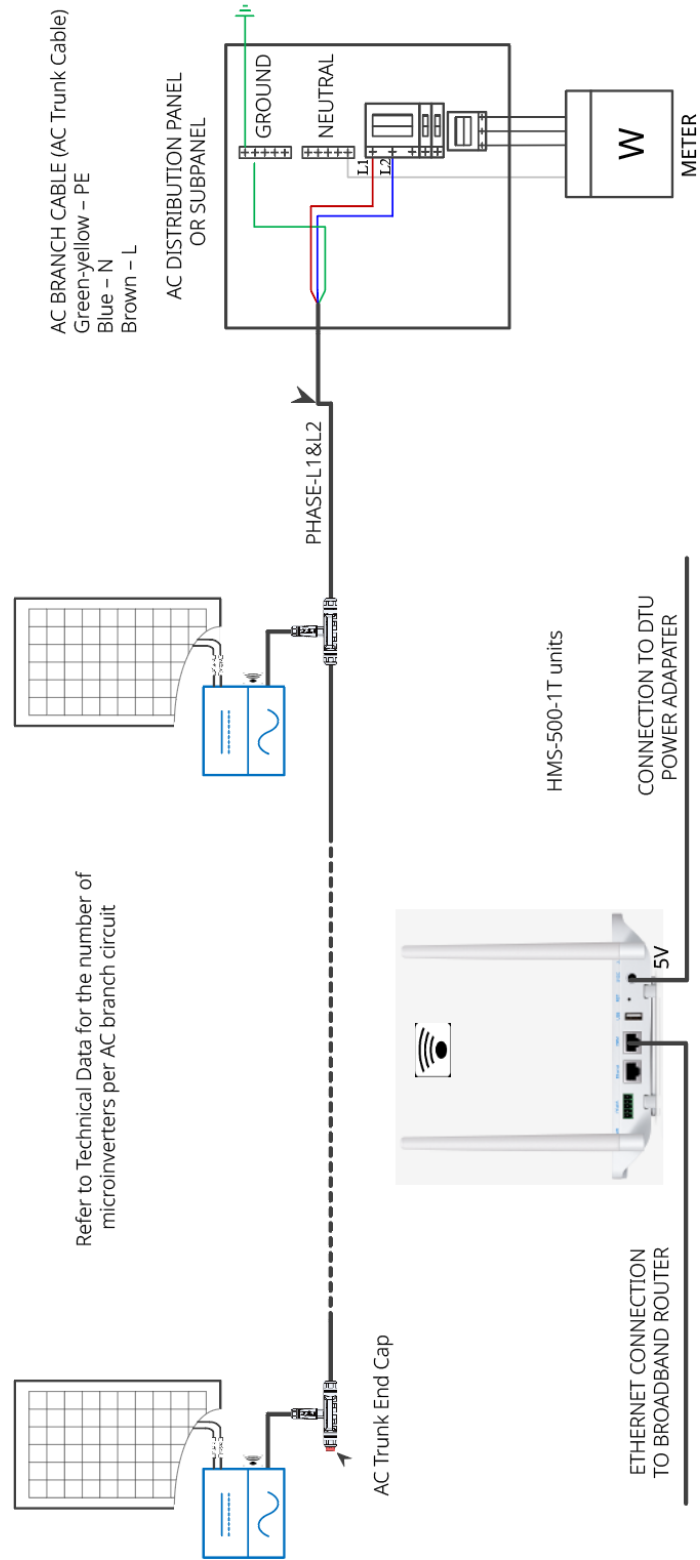

# 11. Appendix 2:

## 11.2 WIRING DIAGRAM – 120VAC / 208VAC THREE PHASE:

